

PLANING + DESIGN

Harper Memorial Library (D38), Third Floor Reading Room

VISUAL CHARACTER OF INTERIOR SPACES

- Room Number: 350
- Floor Level: Third
- Current Department:
- Net Assignable SF:
- Current Department:
- Current Primary Use:
- Current Adjacency:
- Significant Prior Use:
- Significant Prior Department:
- Abuts an external wall: **Yes** No
- Windows: **Light** Views
- Last Major Renovation:
- Period of Significance:
- HRS Rating Interior: 1 2 3 N.A
- Comment -

REGULATORY STATUS

- National Register – no
- NR Historic District – Hyde Park Kenwood
- Chicago Historic Resource Survey Color Code - OR

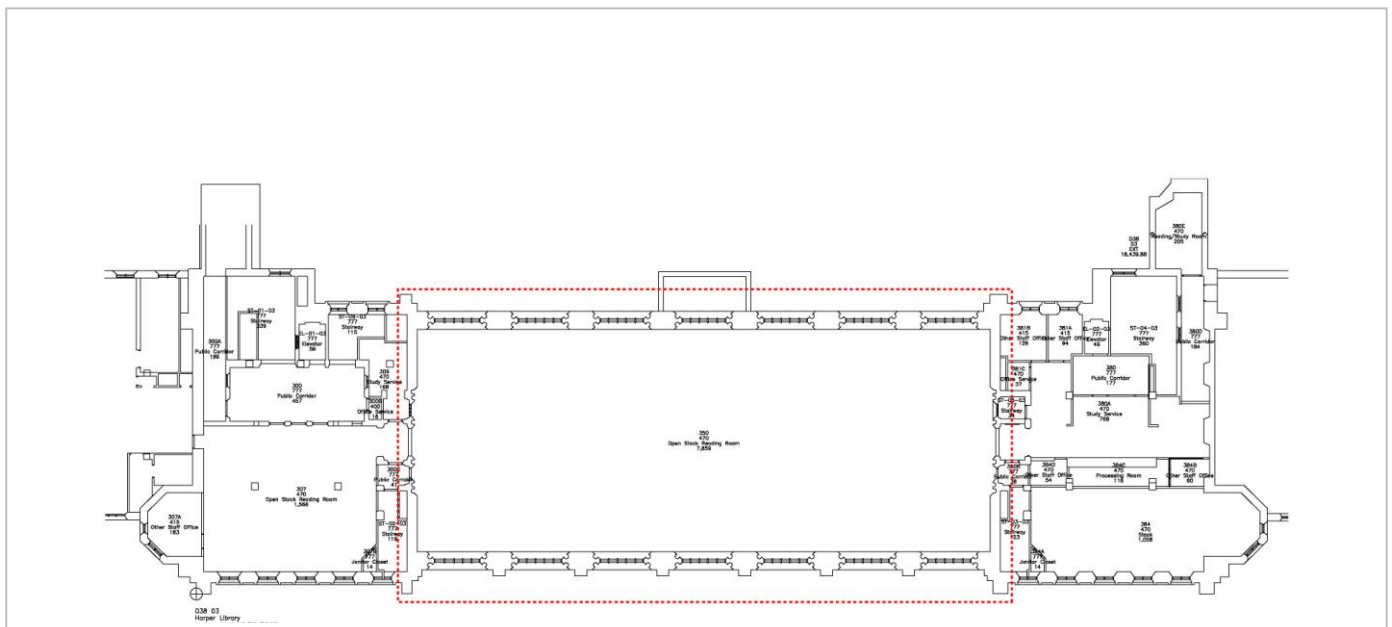
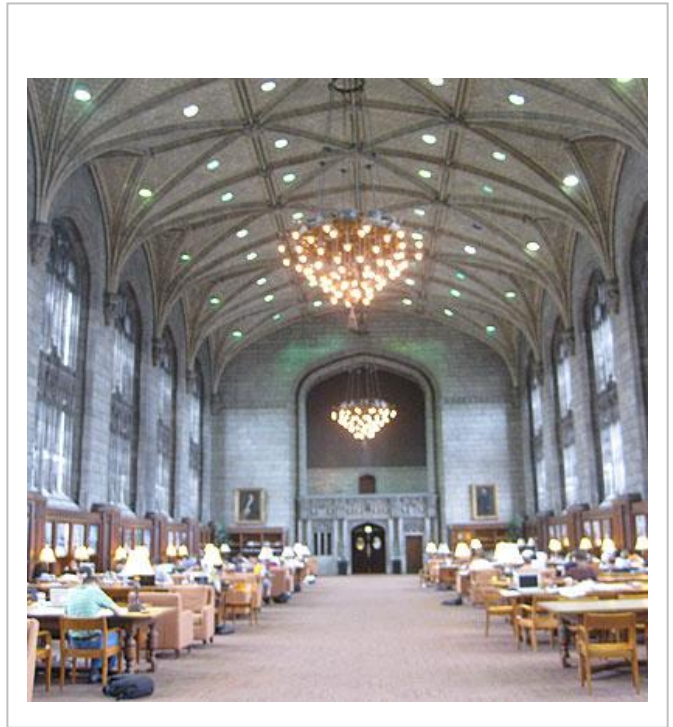

PLANING + DESIGN

Harper Memorial Library (D38), Third Floor Reading Room

I. OVERALL CHARACTER

Importance to the overall character of the building:

Singular interior space that is an iconic University presence.

Architectural Character:

Rich Modest Simple Utilitarian Other

Space Categorization:

Primary Secondary Tertiary

II. INTERCONNECTED INTERRELATED SPACES

Connected to: Main building circulation system.

Program linkages in sequence of spaces:

Visual Linkages in sequence of spaces:

Expansive multi-story space reached after ascending architecturally significant staircases.

Linkages in Planning:

Linkages in Finishes: Similar to circulation spaces – exposed stone, plaster, lead-camed windows. Much richer ornamentation and detail than circulation path leading to it.

III. STRUCTURAL ELEMENTS

Structural System:

Walls: Exposed stone.

Columns: None.

Roof trusses/post & beam construction: Stone clad steel beams.

IV. SIGNIFICANT ELEMENTS

Dominating visual character:

Academic Gothic reading room.

Significant Elements:

Carved stonework, lead camed window units including one bay of completed stained glass inserts in window system. Ornately carved portals

at entrances to rooms. Printers' marks on wall corbels.

Flooring (material, pattern, finish):

Carpeted.

Walls (material, finish, trim):

Limestone with carved limestone trim.

Windows (type, glazing):

Lead-camed units with some stained glass.

Paneling (type, finish):

Residual wood shelving units at perimeter walls.

Ceilings (material, pattern, finish, trim):

Stone ribs with tile spanning between.

Lighting:

Significant large chandeliers.

V. FURNITURE & ARTWORK

Furniture (original, character-defining, finish):

None

Artwork (portraits, paintings, prints, commemorative plaques):

Oil portraits.

VI. ACCESSIBILITY

Space Layout:

VII.

VII. HVAC SYSTEMS

HVAC registers, decorative grilles, window air conditioner, radiators, decorative radiator covers):

None identified.

VIII.

VIII. EQUIPMENT

(Audio Visual, other):

None identified.

IX. CULTURAL SIGNIFICANCE

Historical Event:

Significant Luminaries:

PLANING + DESIGN

Harper Memorial Library (D38), Third Floor Reading Room

Administration/ Faculty/ Alumni/ Community

Review:

Reports in Media: _____

Miscellaneous: _____

X. SPACE CONDITION

ISES DM Interior: _____

ISES DM Systems: _____

Deficiencies: _____

*Building Operability: _____